

4K2K 1080P Android 5.1 Lollipop OS Amlogic S905 1 G + 8G Media Player Kodi16.1 Quad Core MXQ Pro

MXQ Pro

Amlogic S905 Quad Core MXQ Pro

New arrival! Android 5.1.1 Smart TV Box H.265 HEVC Full HD 1080P Android Smart HDMI 2.0 TV Box.



S905



Cortex™ A53



HDMI™ 2.0



H.264
H.265
HEVC



RJ45



Android™ 5.1.1



4K
2K



Mali™-450MP



MXQ Pro	
產品名稱	MXQ Pro
處理器	Amlogic S905 ARM Cortex™-A53 CPU 2.0 GHz (DVFS)
GPU	450 Mhz +
記憶體	8GB EMMC (16 GB)
SDRAM	1GB DDR3 (2 GB)
電源	
電源	DC 5V/2A
LED	紅: 電源
系統	
系統	Android™ 5.1 Lollipop
3D	3D HD 1080Px2
編碼	HD MPEG1/2/4, H.264/ H.265 HD AVC/VC-1, RM/RMVB, Xvid/DivX3/4/5/6 RealVideo8/9/10, HEVC MP-10
格式	Avi/Rm/Rmvb/Ts/Vob/Mkv/Mov/ISO/Wmv/Asf/Flv/Dat/Mpg/Mpeg /MP4
音訊	MP3/WMA/AAC/WAV/OGG/AC3/DDP/TrueHD/DTS/DTS/HD/FLAC
圖片	HD JPEG/BMP/GIF/PNG/TIFF
USB	4 USB 2.0 USB HDD
儲存	SD™ / SDHC/MMC
HDD	FAT16/FAT32/NTFS
介面	SRT/SMI/SSA/IDX + USB
顯示	SD/HD/4K2K HD
OSD	OSD
LAN	100M RJ-45
無線	IEEE802.11 b/g/n (IEEE802.11 b/g/n/ac)
藍牙	USB 2.4GHz USB 2.4GHz
HDMI™	HDMI™ 2.0 (CEC HDCP 2.2) 4K * 2K @60 fps
AV	
3G	
SPDIF/IEC958	
IPTV OTT	IPTV OTT
其他功能	
其他功能	Miracast Airplay, Skype Youtube Picasa, Facebook



HDMI 2.0
Visual—Perfect Transmission



Wifi



CPU Amlogic S905 Quad-core 64-bit
ARM Cortex-A53 up to 2GHz

GPU Penta-core ARM Mali-450



Android 5.1



1GB DDR3
8GB NAND FLASH



Game

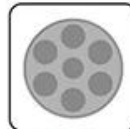

V.O.D



CPU Amlogic S905 Quad-core 64-bit
ARM Cortex-A53 up to 2GHz

GPU Penta-core ARM Mali-450



Android 5.1



1GB DDR3
16GB NAND FLASH



Game

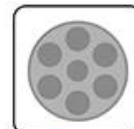

V.O.D



64 Bit

Single cycle processing capacity to improve 1 times

Amlogic S905 solution, the MOST professional Quad core CPU performance for Network Set-top Box.

Full Quad core, 2GHz Ultra high frequency, More than 4 times Performance improvements



Breathtaking Visual Power

4K 1080i/p resolution is 4 times of full HD, so every detail of the screen is lucidity.



Bandwidth saving Lifting speed

H.265 hardware decoding can save 50% bandwidth resources;
Let you watch the 4K movie smoothly



Only two steps, Easy operation

Step 1: Connect to the TV

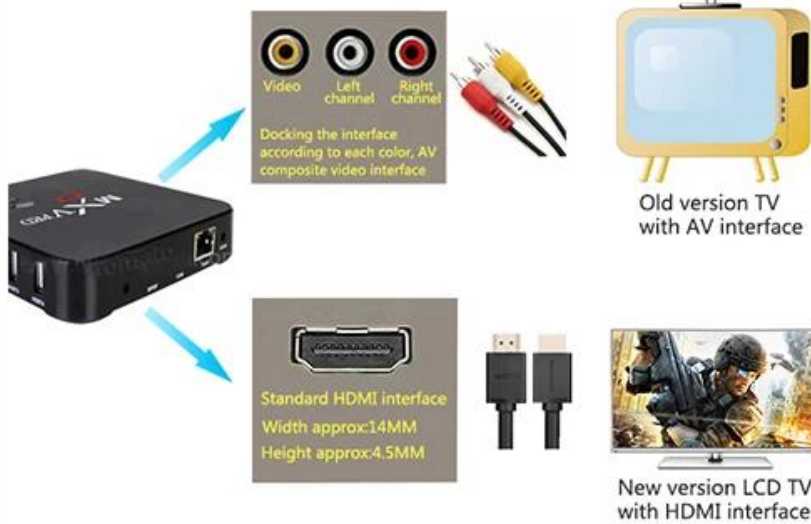

Step 2: Connect to the Internet

