

Enhance Entertainment with Android TV Box (Android 9.0)

specifications	
Template No.	Android TV Box Android 9.0
processor	Short circuit AmCart S905X2 Quad Core Cortex A53 2 GHz
GPU	ARM Dvalin MP2 GPU
rom	LPDDR4: 4 GB
Internal storage	eMMC: 32 GB (Option: 64 GB)
OS	Android 8.1
Audio and video CODEC	
video	<p> ˆ Amlogic Video Engine (AVE) with dedicated hardware decoders and encoders ˆ Supports multi-video decoder up to 4Kx2K at 60fps + 1x1080P at 60fps ˆ Supports multiple "secure" video decoding sessions and simultaneous decoding and encoding ˆ Video / image decoding - VP9 Profile-2 up to 4Kx2K @ 60fps - H.265 HEVC MP-10@L5.1 up to 4Kx2K at 60 fps - AVS2-P2 profile up to 4Kx2K at 60 fps - H.264 AVC HP@L5.1 up to 4Kx2K at 30 fps - H.264 MVC up to 1080P @ 60 fps - MPEG-4 ASP @ L5 up to 1080P @ 60 fps (ISO-14496) - WMV / VC-1 SP / MP / AP up to 1080P @ 60fps - AVS-P16 (AVS +) / AVS-P2 JiZhun profile up to 1080P @ 60 fps - MPEG-2 MP / HL up to 1080P @ 60 fps (ISO-13818) - MPEG-1 MP / HL up to 1080P @ 60 fps (ISO-11172) - RealVideo from 8/9/10 to 1080 P at 60 fps - Support for video subtitles in multiple languages and multiple formats - Unlimited pixel resolution MJPEG and JPEG (ISO / IEC-10918) - Supports thumbnail, resizing, rotation and JPEG transition effects - Supports *.mkv, * formats. Wmv, *. Mpg, *.mpeg, *.dat, *.avi, *.mov, *.iso, *.mp4, *.rm and *.jpg </p>
Audio	<p> Supports MP3, AAC, WMA, RM, FLAC, Ogg and programmable with 7.1 / 5.1 down-mixing SPDIF / IEC958 input / output integrated serial digital audio and PCM input / output TDM / PCM / I2S ports integrated with TDM / PCM mode up to 384kHz x32bits x 8ch or 96kHz x 32bits x 32ch and I2S mode up to 384kHz x 32bits x 8ch PDM digital microphone input with programmable CIC, LPF and & HPF, supports up to 8 DMICs Integrated stereo audio DAC Supports simultaneous output of two stereo audio channels with a combination of analogue + PCM or I2S + PCM </p>
I/O	
1 * HDMI	HDMI 2.1, HDMI CEC support, Dynamic HDR and HDCP 2.2.4Kx2K @ 75 maximum resolution output.
1 * AV OUT	Standard definition output 480i / 576i
2 * USB	1 * USB 3.0; 1 * USB 2.0
1 * IR Reciver	Remote Reciver connection
1 * RJ45	Ethernet interface; Support 10/100 / 1000M
Bluetooth	Bluetooth 4.x + HS; Supports remote voice command
1 * TF CARD	It supports 4 GB / 8 GB / 16 GB / 32 GB / 64 GB
Power	DC 5V / 2A; LED indicator, working: blue;

Others

Image	HD JPEG, BMP, GIF, PNG, TIF
language	English French German Spanish Italian etc. Multilateral languages
Option	Browse all video websites, supports Netflix, Hulu, Flixster, Youtube, etc. Apps download free Android Market, Amazon App Store, etc. Local multimedia playback, Supports HDD, U Disk, TF card.

X96Max Smart Box



Android 8.1
Coming...

Smart , Faster.



X96^{Max} Smart Box



Configuration table

 S905x2	Android 8.1	CPU 4 Core 64bit
ARM Cortex A53	GPU Davlin MP2	LAN 1000M
H.265 HEVC	VP9 HDR10+	WiFi 2.4/5.8G 802.11.ac
4K	BT 4.0	eMMC LPDDR4



X96Max Smart Box



Neural Networks API

Smarter, Faster, and more powerful than ever chipset.

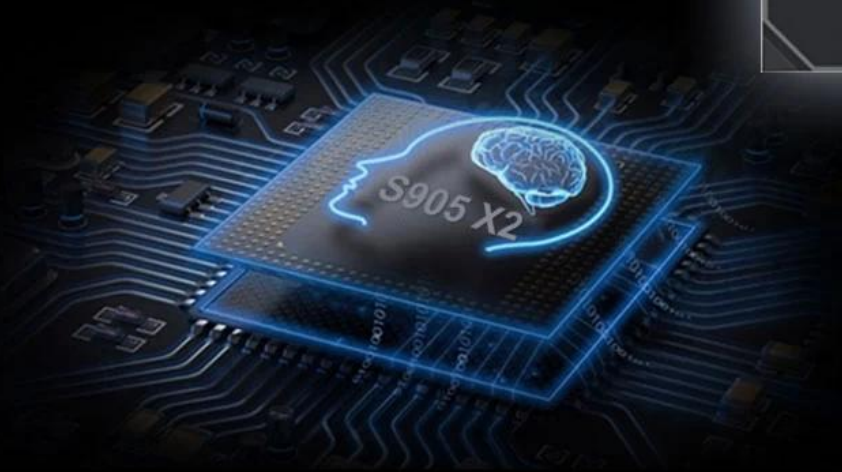

X96Max Smart Box



X96^{Max} Smart Box



New Generation Memory

Say goodbye to Background Cleaning and Sluggish Performances.

We adopted the newest cutting edge LPDDR4 Memory.

4GB
LPDDR4 RAM

32GB
eMMC ROM



X96^{Max} Smart Box



4K

ULTRA HD

X96Max Fully supporting Premium 4K UHD contents with a powerful 64bit CPU and Dvalin MP2 GPU combination in place to handle 4K graphics and offers strkingly realistic pictures.



X96Max Smart Box



AirPlay

Enjoy it on the big screen
And the best speakers



Mirecast

Your video/ music/photo from your Android devices /ios devices through
DLNA /Airplay/onto big screen.
Enjoy the best fast best gaming& entertainment experience



X96_{Max} Smart Box



X96Max Support HDR+



HDR makes it's possible that color gamut expands 100% and maximum

X96Max Smart Box



LCD Pannel:

Time: System Time Display.

HD: HD Video Output Status Display.

CVBS: AV Status Display.

USB: USB Mount Status Display.

CARD: TF Card Mount Status Display.

X96^{Max} Smart Box



SuperSpeed USB
Theoretical speed
up to **5Gbps**
(practical speed
up to 300MB/s)

VS



High speed USB
Theoretical speed
up to **480Mbps**
(practical speed
up to 35/40MB/s)



USB3.0



X96Max Smart Box

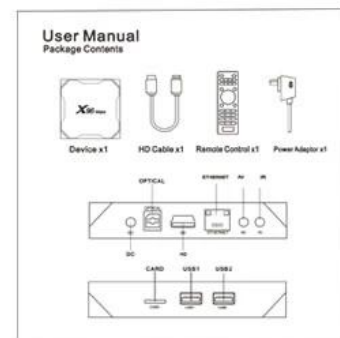

Experience your favorite movies, TV shows, games, and apps in stunning high-definition quality. [Android TV Box](#) 9.0 is designed to provide exceptional speed and responsiveness, ensuring a smooth and immersive viewing experience. It's equipped with built-in Wi-Fi and multiple ports, making connectivity a breeze.