

Amlogic S905X4 TV Box Specifications

General	
Model	S905X4 TV Box
CPU	Amlogic S905X4 64-bit ARM® Cortex™ A55 CPU
GPU	ARM Mali-G31 MP2 OpenGL ES 1.1/2.0/3.2, OpenCL 2.0, Vulkan 1.1
RAM	4GB (2GB/4GB)
ROM	64GB(16GB/32GB/64GB/128GB)
OS	Android 11
Network	2.4G / 5G Wi-Fi, WiFi IEEE 802.11 b / g / n / ac
Bluetooth	BT4.X
Video & Audio	
Video	<ul style="list-style-type: none"> Support Amlogic Engine(AVE) 4x1080P@60fps "4K" 8Kx4K@24fps VP9 8Kx4K@24fps H.265 HEVC MP-10@L5.1 8Kx4K@24fps 8Kx4K@24fps AVS2-P2 MPEG-4 ASP@L5 1080P@60fps(ISO-14496) WMV/VC-1 SP/MP/AP 1080P@60fps AVS-P16(AVS) /AVS-P2 JiZhun 1080P@60fps MPEG-2 MP/HL 1080P@60fps(ISO-13818) MPEG-1 MP/HL 1080P@60fps(ISO-11172) RealVideo 8/9/10 1080P@60fps MJPEG / JPEG (ISO/IEC-10918) JPEG, GIF, PNG, BMP, TIF *.mkv, *.wmv, *.mpg, *.mpeg, *.dat, *.avi, *.mov, *.iso, *.mp4, *.rm, *.jpg
Audio	MP3, AAC, WMA, RM, FLAC, Ogg
Ports	
1*HDMI	4K*2K UHD, HDMI 1.4/2.0
1*AV	480i/576i
3*USB	1*USB 3.0 2*USB 2.0
1*IR	IR Remote
1*RJ45	1000M Ethernet
1*SD	SD Card
Power	DC 5V/2A
Software	
Video	HD JPEG, BMP, GIF, PNG, TIF
Audio	MP3, AAC, WMA, RM, FLAC, Ogg
Apps	Netflix, YouTube, Amazon Prime Video, etc.

Amlogic S905X4
 Amlogic S905X4 64-bit Arm Cortex-A55 @ 2.0GHz(OpenGL ES3.2, Vulkan 1.1 & OpenCL 2.0)
 Arm Mali-G31MP2
 SMemory - 2GB DDR (Options: 1GB or 4GB)
 Storage - 8GB eMMC (Options: 16GB, 32GB, 64GB), MicroSD

Video

□□ - HDMI 2.1 □□ 4K @ 60Hz(CEC □ HDCP2.2 □□), AV □□(□□□□ □□□ □□)

□□ - HDMI □□(TBC)

□□□ - AV □□□ □□ □□□□ □□□□ □□□, HDMI□ □□ □□□ □□□ □□ S/PDIF

□□□ □□

□□

AV1 □□ 4K @ 120fps

H.265 HEVC MP-10 □□ 4K @ 75fps

VP9 □□ 4K @ 75fps

AVS2-P2 □□ 4K @ 75fps

H.264 AVC □□ 4K @ 30fps

MPEG1/2/4 ASP, WMV/VC-1, RealVideo8/9/10,

HDR - HDR 10, HLG, PRIME HDR, TCH PRIME, □□ HDR10, □□ Dolby Vision

DRM - Google Widevine □ Microsoft PlayReady; □□: Verimatrix, Irdeto MSR2.2, Nagra TKL

□□ - 10/100M □□□(□□□□ □□□ □□), Wi-Fi 5 802.11 a/b/g/n/ac MiMO, Bluetooth 4.2

USB - USB 3.0 □□ 1□, USB 2.0 □□ 1□

□□ - □□ □□; □□, IR □ □□□□ LED; IR □□□

□□ □□ □□ - DC □□ □□ 5V/2A

X4

amlogic

S905X4

8K

Video CODEC

CPU

Cortex A55
4 Core 64bit

GPU

Mali G31 MP2

ANDROID

11

VP9

HDR 10+

AV1

AV1 MP-10@L5.1
4Kx2K@60fps

WiFi

2.4G/5G
802.11ac

BT

4.1



Amlogic Quad-core 64 bit

The S905X4 chipset is an advanced application processor with AV1 video codec, secured 4K video codec engine and HDR image processing functions.

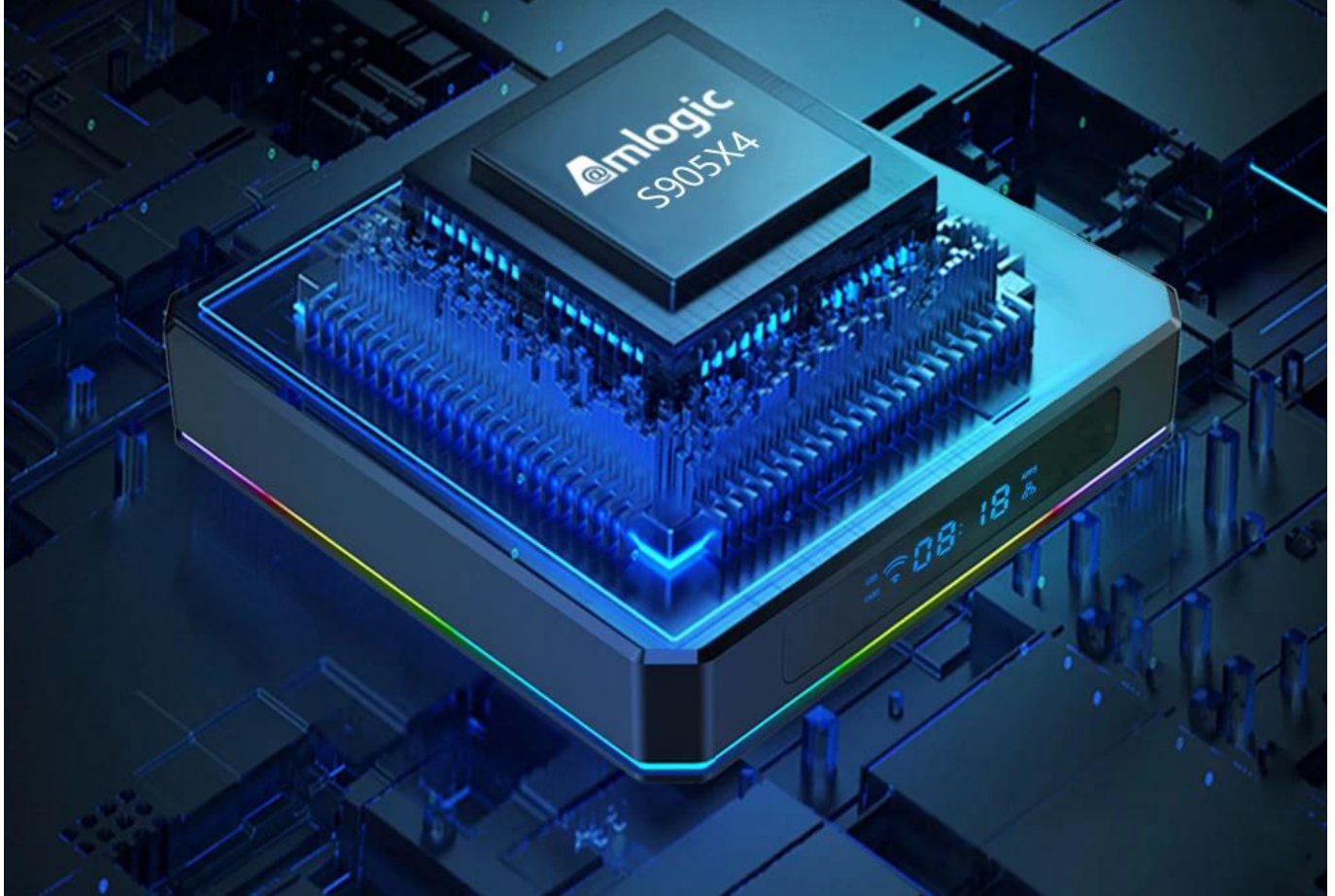

Android 11

Application installation is more flexible



WiFi 2.4G&5G&802.11ac

Dual WiFi design , Faster transmission
and more stable signal





BT4.1

Fast, stable, multi-devices connection

Available external devices via BT function

Reading speed
USB 2.0 : Max 60M/s
USB 3.0 : Max 500M/s

Phone Hard Drive U disk

USB3.0 with super fast data-read speed

Smooth, stable, and fast playback of local videos. You can share the happy moment on TV together.



DLNA



Airplay



Miracast



Leisure and entertainment

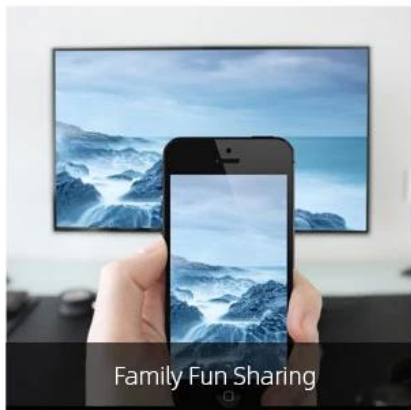

Family Fun Sharing

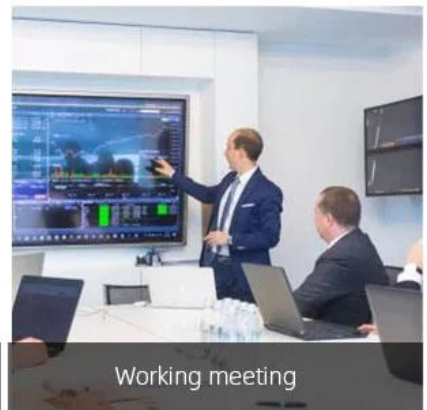

Working meeting

Ultra high quality

Ultra-high-definition 4K resolution with a new generation of HDR image quality engine. Rich details display to let you see the world more clearly. 8K video decoding engine supported, which bring you more exciting content.

SDR



4K



Support Vulkan1.1, Support OpenGL ES3.2

Cooler graphics, more fun to playing games



COLORFUL LIGHTING EFFECT

20 psychedelic lighting effects with multiple colors on your choice. Brighten your colorful life!



AV1

More videos for less data.

AV1 is 30% better than H.265 or VP9.

AV1

↑ 20%-30%

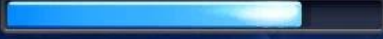

VP9



H. 265



Various Interfaces

Various interfaces such as HDMI, LAN, USB, etc. which bring you a smart and colorful enjoyment.

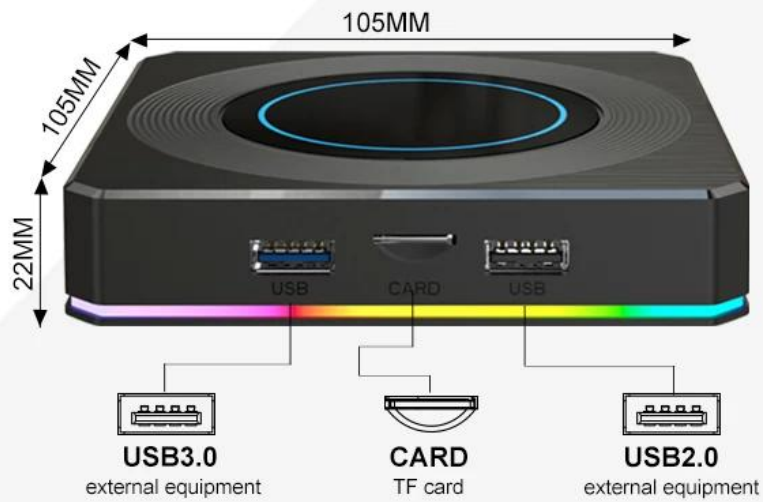
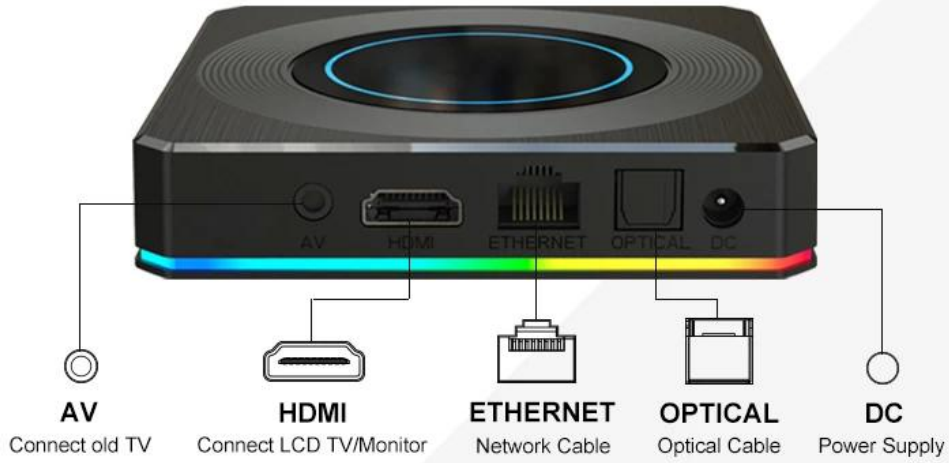



Package Contents



Power Supply*1



HD data cable*1

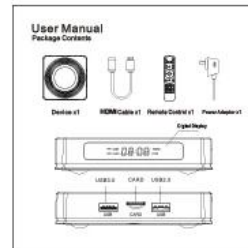

User Manual*1



Remote Control*1

此款 Android 11 電視 TV 採用 Amlogic S905X4 晶片，支援 4K 超高清畫質。此款電視支援 HDR10+ 畫質，畫面更清晰、更亮。此款電視支援 Dolby Digital 音訊，音質更優美。此款電視支援 AI 語音助手，操作更簡便。此款電視支援多種語言，滿足不同地區用戶的需求。此款電視支援多種應用，滿足不同用戶的娛樂需求。此款電視支援多種接口，滿足不同用戶的連接需求。此款電視支援多種功能，滿足不同用戶的使用需求。此款電視支援多種規格，滿足不同用戶的選購需求。此款電視支援多種品牌，滿足不同用戶的購買需求。此款電視支援多種渠道，滿足不同用戶的購買渠道需求。此款電視支援多種服務，滿足不同用戶的售後服務需求。此款電視支援多種保障，滿足不同用戶的購買保障需求。此款電視支援多種認證，滿足不同用戶的購買認證需求。此款電視支援多種標準，滿足不同用戶的購買標準需求。此款電視支援多種認證，滿足不同用戶的購買認證需求。此款電視支援多種標準，滿足不同用戶的購買標準需求。