

TV Box 8.1 -

| | |
|---|--|
| <p> 1 * HDMI 1 * AV 2 * USB 1 * IR 1 * RJ45 1 * TF DC 5V / 2A; LED </p> | |
| <p> 1 * HDMI 1 * AV 2 * USB 1 * IR 1 * RJ45 1 * TF DC 5V / 2A; LED </p> | <p> HDMI 2.1, HDMI CEC, Dynamic HDR, HDCP 2.2.4Kx2K @ 75 480i / 576i 1 * USB 3.0; 1 * USB 2.0 IR 10/100 / 1000M 4.x HS; 4GB / 8GB / 16GB / 32GB / 64GB DC 5V / 2A; LED </p> |
| <p> MP3, AAC, WMA, RM, FLAC, Ogg 7.1/5.1 SPDIF/IEC958 PCM 384kHz x32 x 8ch 96kHz x 32 x 32ch TDM/PCM 384kHz x 32 x 8ch I2S TDM/PCM/I2S CIC, LPF HPF PDM 8 DMIC DAC PCM I2S PCM 2 </p> | |
| <p> VP9-2 4Kx2K @ 60fps H.265 HEVC MP-10@L5.1 60fps 4Kx2K 60fps 4Kx2K AVS2-P2 H.264 AVC HP@L5.1 30fps 4Kx2K H.264 MVC 1080P @ 60fps MPEG-4 ASP @ L5 1080P @ 60fps(ISO-14496) WMV / VC-1 SP / MP / AP 1080P @ 60fps AVS-P16(AVS) / AVS-P2 JiZhun 1080P @ 60fps MPEG-2 MP/HL 1080P @ 60fps(ISO-13818) MPEG-1 MP/HL 1080P @ 60fps(ISO-11172) 60fps 8/9/10 1080P RealVideo MJPEG JPEG(ISO/IEC-10918) JPEG *.mkv, *.wmv, *.mpg, *.mpeg, *.dat, *.avi, *.mov, *.iso, *.mp4, *.rm, *.jpg </p> | |
| <p> Amlogic Video Engine(AVE) 60fps 4Kx2K 60fps 1x1080P "AVS" </p> | |
| <p> TV AmCart S905X2 Cortex A53 2GHz ARM MP2 GPU LPDDR4: 4GB eMMC: 32GB(64GB) Android 8.1 </p> | |

| | |
|----|---|
| 格式 | |
| 格式 | HD JPEG, BMP, GIF, PNG, TIF |
| 格式 | 支持 1080P 高清视频播放 |
| 格式 | 支持 1080P 高清视频播放, 支持 1080P 高清视频播放, 支持 1080P 高清视频播放. 支持 Android 应用, Amazon App Store 应用. 支持 1080P 高清视频播放, HDD, U 盘, TF 卡. |

X96Max Smart Box



Android 8.1 Coming...

Smart , Faster.



X96Max Smart Box



Configuration table

| | | |
|--|--------------------------|--------------------------------------|
|  S905x2 | Android 8.1 | CPU 4 Core 64bit |
| ARM Cortex A53 | GPU Davlin MP2 | LAN 1000M |
| H.265 HEVC | VP9 HDR10+ | WiFi 2.4/5.8G 802.11.ac |
| 4K | BT 4.0 | eMMC LPDDR4 |



X96^{Max} Smart Box



Neural Networks API

Smarter, Faster, and more powerful than ever chipset.

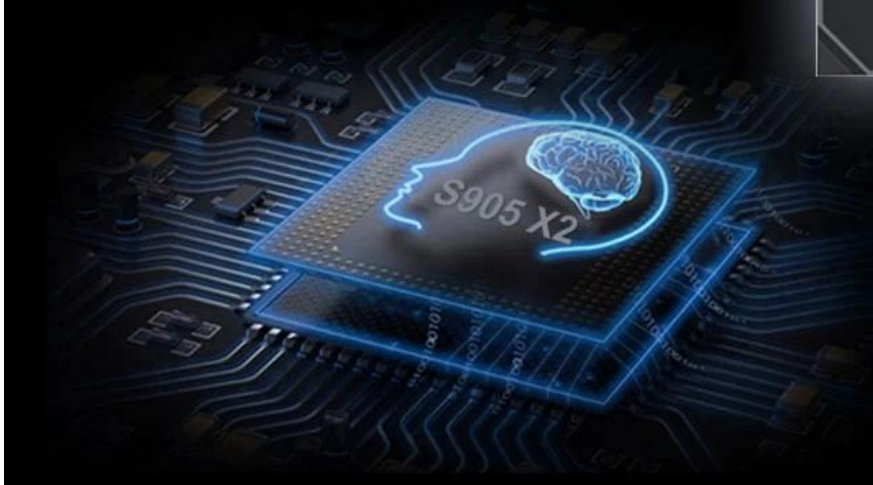

X96Max Smart Box



5V

OPTICAL

HD

ETHERNET

AV

IR

USB3.0

USB2.0

CARD

X96^{Max} Smart Box



New Generation Memory

Say goodbye to Background Cleaning and Sluggish Performances.

We adopted the newest cutting edge LPDDR4 Memory.

4GB
LPDDR4 RAM

32GB
eMMC ROM

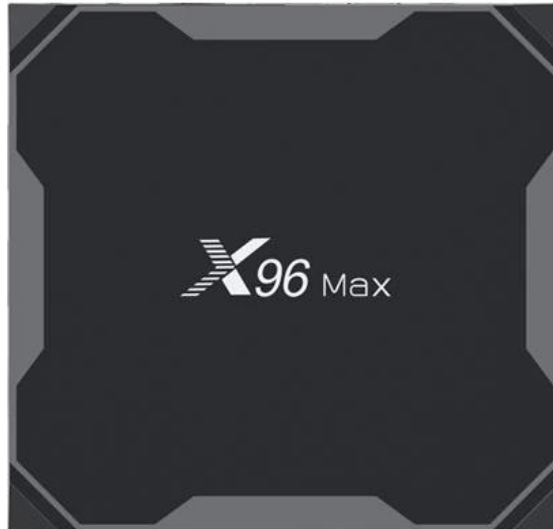

X96^{Max} Smart Box



4K

ULTRA HD

X96^{Max} Fully supporting Premium 4K UHD contents with a powerful 64bit CPU and Dvalin MP2 GPU combination in place to handle 4K graphics and offers strikingly realistic pictures.



X96Max Smart Box



AirPlay

Enjoy it on the big screen
And the best speakers



Your video/ music/photo from your Android devices /ios devices through DLNA /Airplay/onto big screen.
Enjoy the best gast best gaming& entertainment experience



X96_{Max} Smart Box



X96_{Max} Support HDR+



HDR makes it's possible that color gamut expands 100% and maximum

X96^{Max} Smart Box



LCD Pannel:

Time: System Time Display.

HD: HD Video Output Status Display.





CVBS: AV Status Display.

USB: USB Mount Status Display.

CARD: TF Card Mount Status Display.

X96^{Max} Smart Box



| | | |
|---|-----------|---|
|   USB 3.0 SuperSpeed USB Theoretical speed up to 5Gbps (practical speed up to 300MB/s) | VS |   USB 2.0 High speed USB Theoretical speed up to 480Mbps (practical speed up to 35/40MB/s) |
|---|-----------|---|



USB3.0



X96Max Smart Box

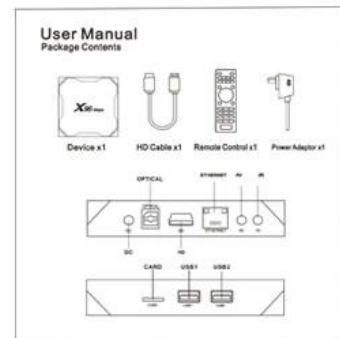

በዚህ ስልጠና ላይ ለመሳሪያው የተዘጋጀውን ሰነድ ለማንበብ [በዚህ ስልጠና ላይ](#) ጎብኙ። ለተጨማሪ መረጃ፣ ወይም ለማንኛውም ጥያቄዎች ለጥያቄዎችዎ ጥያቄ ያቀሙ። ለተጨማሪ መረጃ፣ ወይም ለማንኛውም ጥያቄዎች ለጥያቄዎችዎ ጥያቄ ያቀሙ። ለተጨማሪ መረጃ፣ ወይም ለማንኛውም ጥያቄዎች ለጥያቄዎችዎ ጥያቄ ያቀሙ። ለተጨማሪ መረጃ፣ ወይም ለማንኛውም ጥያቄዎች ለጥያቄዎችዎ ጥያቄ ያቀሙ።