

Immerse in Innovation Android TV Box with Android 9.0 - Elevate Your Entertainment

| specifications | |
|-----------------------|--|
| Template No. | Android TV Box |
| processor | Short circuit AmCart S905X2 Quad Core Cortex A53 2 GHz |
| GPU | ARM Dvalin MP2 GPU |
| rom | LPDDR4: 4 GB |
| Internal storage | eMMC: 32 GB (Option: 64 GB) |
| OS | Android 8.1 |
| Audio and video CODEC | |
| video | <ul style="list-style-type: none"> • Amlogic Video Engine (AVE) with dedicated hardware decoders and encoders • Supports multi-video decoder up to 4Kx2K at 60fps + 1x1080P at 60fps • Supports multiple "secure" video decoding sessions and simultaneous decoding and encoding • Video / image decoding <ul style="list-style-type: none"> - VP9 Profile-2 up to 4Kx2K @ 60fps - H.265 HEVC MP-10@L5.1 up to 4Kx2K at 60 fps - AVS2-P2 profile up to 4Kx2K at 60 fps - H.264 AVC HP@L5.1 up to 4Kx2K at 30 fps - H.264 MVC up to 1080P @ 60 fps - MPEG-4 ASP @ L5 up to 1080P @ 60 fps (ISO-14496) - WMV / VC-1 SP / MP / AP up to 1080P @ 60fps - AVS-P16 (AVS +) / AVS-P2 JiZhun profile up to 1080P @ 60 fps - MPEG-2 MP / HL up to 1080P @ 60 fps (ISO-13818) - MPEG-1 MP / HL up to 1080P @ 60 fps (ISO-11172) - RealVideo from 8/9/10 to 1080 P at 60 fps - Support for video subtitles in multiple languages and multiple formats - Unlimited pixel resolution MJPEG and JPEG (ISO / IEC-10918) - Supports thumbnail, resizing, rotation and JPEG transition effects - Supports * .mkv, * formats. Wmv, *. Mpg, * .mpeg, * .dat, * .avi, * .mov, * .iso, * .mp4, * .rm and * .jpg |
| Audio | <p>Supports MP3, AAC, WMA, RM, FLAC, Ogg and programmable with 7.1 / 5.1 down-mixing</p> <p>SPDIF / IEC958 input / output integrated serial digital audio and PCM input / output</p> <p>TDM / PCM / I2S ports integrated with TDM / PCM mode up to 384kHz x32bits x 8ch or 96kHz x 32bits x 32ch and I2S mode up to 384kHz x 32bits x 8ch</p> <p>PDM digital microphone input with programmable CIC, LPF and & HPF, supports up to 8 DMICs</p> <p>Integrated stereo audio DAC</p> <p>Supports simultaneous output of two stereo audio channels with a combination of analogue + PCM or I2S + PCM</p> |
| I/O | |
| 1 * HDMI | HDMI 2.1, HDMI CEC support, Dynamic HDR and HDCP 2.2.4Kx2K @ 75 maximum resolution output. |
| 1 * AV OUT | Standard definition output 480i / 576i |
| 2 * USB | 1 * USB 3.0; 1 * USB 2.0 |
| 1 * IR Reciver | Remote Reciver connection |
| 1 * RJ45 | Ethernet interface; Support 10/100 / 1000M |
| Bluetooth | Bluetooth 4.x + HS; Supports remote voice command |
| 1 * TF CARD | It supports 4 GB / 8 GB / 16 GB / 32 GB / 64 GB |

| | |
|---------------|--|
| Power | DC 5V / 2A; LED indicator, working: blue; |
| Others | |
| Image | HD JPEG, BMP, GIF, PNG, TIF |
| language | English French German Spanish Italian etc. Multilateral languages |
| Option | Browse all video websites, supports Netflix, Hulu, Flixster, Youtube, etc. Apps download free Android Market, Amazon App Store, etc. Local multimedia playback, Supports HDD, U Disk, TF card. |

X96^{Max} Smart Box



Android 8.1

Coming...

Smart, Faster.



X96Max Smart Box



Configuration table

| | | |
|--|--------------------------|--------------------------------------|
|  S905x2 | Android 8.1 | CPU 4 Core 64bit |
| ARM Cortex A53 | GPU Davlin MP2 | LAN 1000M |
| H.265 HEVC | VP9 HDR10+ | WiFi 2.4/5.8G 802.11.ac |
| 4K | BT 4.0 | eMMC LPDDR4 |



X96^{Max} Smart Box



Neural Networks API

Smarter, Faster, and more powerful than ever chipset.



X96Max Smart Box



5V

OPTICAL

HD

ETHERNET

AV

IR

USB3.0

USB2.0

CARD

X96^{Max} Smart Box



New Generation Memory

Say goodbye to Background Cleaning and Sluggish Performances.

We adopted the newest cutting edge LPDDR4 Memory.

4GB
LPDDR4 RAM

32GB
eMMC ROM



X96^{Max} Smart Box



4K

ULTRA HD

X96^{Max} Fully supporting Premium 4K UHD contents with a powerful 64bit CPU and Dvalin MP2 GPU combination in place to handle 4K graphics and offers strikingly realistic pictures.



X96Max Smart Box



AirPlay

Enjoy it on the big screen
And the best speakers



Your video/ music/photo from your Android devices /ios devices through DLNA /Airplay/onto big screen.
Enjoy the best gast best gaming& entertainment experience



X96_{Max} Smart Box



X96_{Max} Support HDR+



HDR makes it's possible that color gamut expands 100% and maximum

X96^{Max} Smart Box



LCD Pannel:

Time: System Time Display.

HD: HD Video Output Status Display.

CVBS: AV Status Display.

USB: USB Mount Status Display.

CARD: TF Card Mount Status Display.

X96^{Max} Smart Box



| | | |
|---|-----------|---|
|   USB 3.0 SuperSpeed USB Theoretical speed up to 5Gbps (practical speed up to 300MB/s) | VS |   USB 2.0 High speed USB Theoretical speed up to 480Mbps (practical speed up to 35/40MB/s) |
|---|-----------|---|



USB3.0



X96Max Smart Box

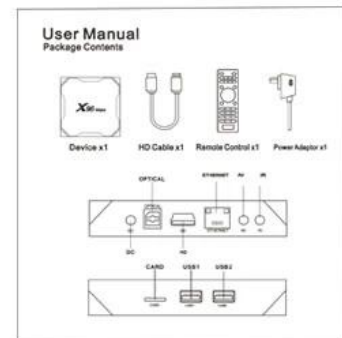

Experience the power of entertainment with our [Android TV Box](#) running on Android 9.0. Transform your TV into a smart hub, unlocking seamless streaming, gaming, and more. This TV box combines the latest Android technology with user-friendly features, providing an immersive viewing experience. Elevate your entertainment setup with the efficiency and versatility of our TV Box Android 9.0. Order now and enjoy a new level of connectivity and convenience in the world of smart entertainment.